

PRODUCT DATA SHEET

Part number	1A9407
EAN	4015609064137
Manufacturer	WALTER-WERKE
WEEE-Reg.-Nr:	DE 22131895

Product description

CEE High current wall socket 200A 4P 7h IP67 C-Line with screw terminal and one top entry



Product image

Detailed product description

WALTER CEE High current wall socket
 with screw terminal
 200A 4P 7h IP67 500V ~
 enclosure front part made from aluminium
 enclosure rear part made from plastic
 with high temperature resisting contact carriers
 with one cable gland 34 - 66 mm
 for external fixing
 C-Line

Ordering information

order unit	Piece
customs number	85366990
net weight	4.3 kg
packing quantity(VPE)	1
length of the packaging	0.36 m
width of the packaging	0.24 m
depth of the packaging	0.2 m
gross weight(VPE)	4.3 kg

Conformities

CE conformity	√
RoHS directive	2011/65/EU

Classification system

classification system	ETIM_7.0
ETIM Class	EC001322

Technical product data

construction type	wall socket
amperage	200 A
rated current	250 A
rated frequency	50/60 Hz
number of poles	4
clock hour position	7 h
voltage	500 V
rated voltage	1000 V
test voltage (1min/50Hz)	4000 V
degree of protection (IP)	IP67
mechanical protection	IK10
strain energy	20 Joule
ambient temperature	-40 - 100 °C
min. connection cross section, rope EN 60228 class 5	35 mm ²
max. connection cross section, rope EN 60228 class 5	150 mm ²
max. connection cross section pilot, wire EN 60228 class 5	4 mm ²
cable diameter	34-66 mm
cable diameter - separate pilot cable	5-10 mm
contact screws	M8
tightening torque contact screws	8 Nm
tightening torque pilot contacts	1.4 Nm
chemical resistance	
- acetic acid	√
- citric acid	√
- lactic acid	√
- sodium hydroxide	√
- isopropanol	√
- methanol	√
- ethanol	√

- hydrogen peroxide	✓
- n-hexane	✓
- toluene	✓
- iso-octane	✓
- acetone	✓
- diethyl ether	✓
- SAE10W40 multigrade oil	✓
- diesel oil	✓
- ethyl acetate	✓

Dimension sheet

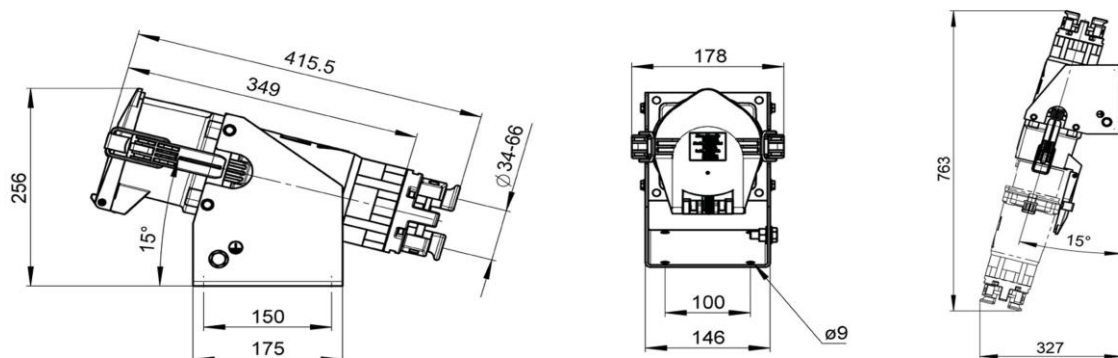

Kabel ohne Pilotkontakte

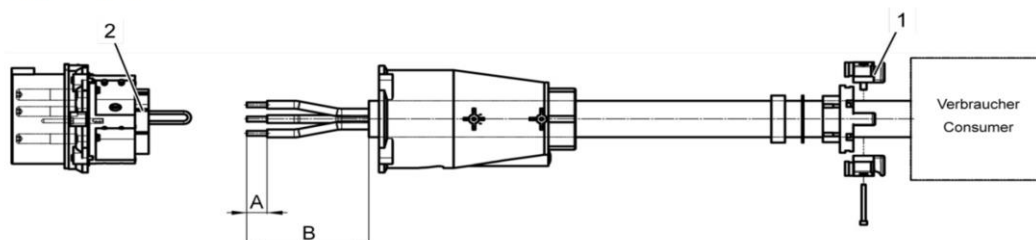

1 Kabelverschraubung

2 Kontaktbuchsen

1.		C-Line	B-Line
Länge		200 A – 250 A	250 A - 400 A
A		30 mm	60 mm
B		150 mm	200 mm