

PRODUCT DATA SHEET

Part number 236306PW

EAN 4015609173709

Manufacturer WALTHER-WERKE

WEEE-Reg.-Number: DE 22131895

Product description

MONDO angled plug 32A 3P 6h with back part in pearl white

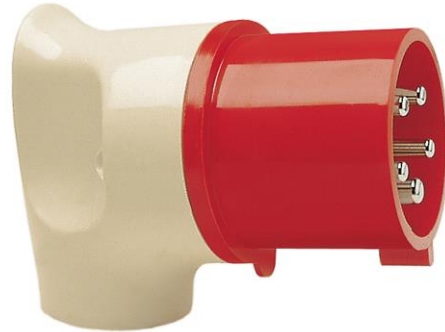

Similar image

Detailed product description

WALTHER angled Plug 32A 3P 230V 6h IP44
 from the MONDO series
 made from PA6 material
 with screw terminal
 back part in pearl white (RAL 1013)

Ordering Information

| | |
|-------------------------|----------|
| Order unit | Piece |
| Customs number | 85366990 |
| Net weight | 0,214 kg |
| Packing quantity (VPE) | 10 |
| Length of the packaging | 0,31 m |
| Width of the packaging | 0,255 m |
| Depth of the packaging | 0,15 m |
| Gross weight(VPE) | 2,336 kg |

Certificates

VDE/ENEC certification 40021520



Classification system

| | |
|-----------------------|----------|
| Classification system | ETIM_6.0 |
| ETIM Class | EC000140 |

Technical product data

| | |
|---------------------------------------|-----------------------|
| IEC-amperage | 32 A |
| Amperage acc. UL/CSA (for UL-version) | 30 A |
| Number of poles | 3 |
| Voltage acc. EN 60309-2 | 230 V (50+60 Hz) blue |
| Clock hour position | 6 h |
| Identification colour | Blue |
| RAL-number | 5002 |
| Degree of protection (IP) | IP44 |
| Connection system | Screwed terminal |
| Cable entry | Anti-kink sleeve |
| Angle of plug | Angled |
| Material | Plastic |

Dimension sheet

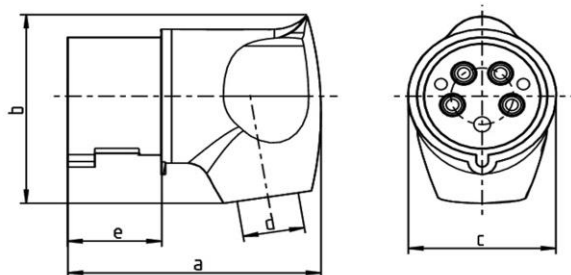

| Amp. | 16 | | | 32 | | |
|------|------|---------|---------|-------|-------|-------|
| | 3 | 4 | 5 | 3 | 4 | 5 |
| a | 85 | 98 | 98 | 115 | 115 | 115 |
| b | 70 | 86 | 86 | 96 | 96 | 100 |
| c | 50,3 | 64,3 | 64,3 | 72 | 72 | 72 |
| d | 8/15 | 10/16,5 | 10/16,5 | 11/22 | 11/22 | 11/22 |
| e | 37 | 37 | 37 | 45,8 | 45,8 | 45,8 |