

## PRODUCT DATA SHEET

---

Part number **7419511**

EAN **4015609150465**

Manufacturer **WALTHER-WERKE**

WEEE-Reg.-Number: **DE 22131895**

### Product description

---

Waterproof CEPro Panel socket straight 16A 5P  
 11h with screwed flange 80x80mm



Similar image

### Detailed product description

---

WALTHER CEPro Panel socket 16A 5P 440V 11h IP67  
 made from PA6 material  
 straight  
 for maximum nine control contacts  
 with screwed flange  
 a compact solution for power and control  
 flange 80x80mm  
 fixing center 60x60mm

### Ordering Information

---

Order unit	Piece
Customs number	85366990
Net weight	0,247 kg
Packing quantity (VPE)	10
Length of the packaging	
Width of the packaging	
Depth of the packaging	
Gross weight(VPE)	2,47 kg

## Classification system

Classification system	ETIM_6.0
ETIM Class	EC001317

## Technical product data

IEC-amperage	16 A
Number of poles	5
Voltage acc. EN 60309-2	400-440 V (50+60 Hz) red
Clock hour position	11 h
Identification colour	Red
RAL-number	3000
Degree of protection (IP)	IP67
Connection system	Screwed terminal
Angle of plug	Straight
Material	Plastic
Military model	False
Flange size vertical	80 mm
Drill hole distance vertical	60 mm
Flange size horizontal	80 mm
Drill hole distance horizontal	60 mm

## Dimension sheet

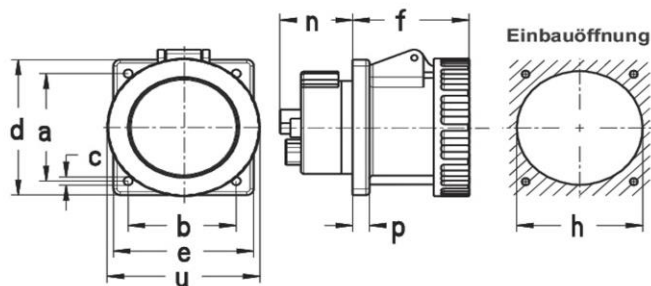

Amp.	16		32
Pole	3	5	5
a	47	60	60
b	47	60	60
c	5,5	5,5	5,5
d	62	80	80
e	62	80	80
f	57	59	70
h	46	67	71
n	22	22	23
p	8,5	8,5	8,5
u	72	88	103