

PRODUCT DATA SHEET

Part number 7439511

EAN 4015609150502

Manufacturer WALTHER-WERKE

WEEE-Reg.-Number: DE 22131895

Product description

Waterproof CEPro Panel socket angled 32A 5P 11h with screwed flange 75x90mm



Similar image

Detailed product description

WALTHER CEPro Panel socket 32A 5P 440V 11h IP67
 made from PA6 material
 straight
 for maximum ten control contacts
 with screwed flange
 a compact solution for power and control
 flange 80x80mm
 fixing center 60x60mm

Ordering Information

Order unit	Piece
Customs number	85366990
Net weight	0,32 kg
Packing quantity (VPE)	10
Length of the packaging	
Width of the packaging	
Depth of the packaging	
Gross weight(VPE)	3,2 kg

Classification system

Classification system	ETIM_6.0
ETIM Class	EC001317

Technical product data

IEC-amperage	32 A
Number of poles	5
Voltage acc. EN 60309-2	400-440 V (50+60 Hz) red
Clock hour position	11 h
Identification colour	Red
RAL-number	3000
Degree of protection (IP)	IP67
Connection system	Screwed terminal
Angle of plug	Straight
Material	Plastic
Military model	False
Flange size vertical	80 mm
Drill hole distance vertical	60 mm
Flange size horizontal	80 mm
Drill hole distance horizontal	60 mm

Dimension sheet

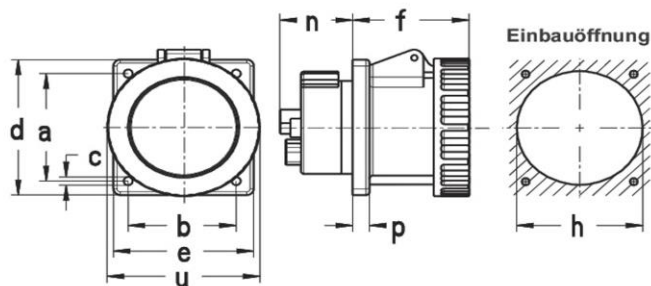

Amp.	16		32
Pole	3	5	5
a	47	60	60
b	47	60	60
c	5,5	5,5	5,5
d	62	80	80
e	62	80	80
f	57	59	70
h	46	67	71
n	22	22	23
p	8,5	8,5	8,5
u	72	88	103